

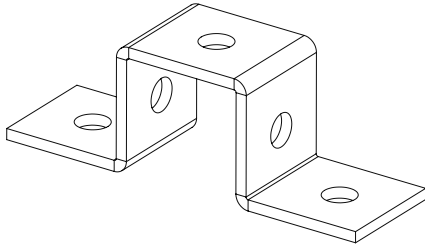

Certificado Nº SGI 3198065/11

Certificado Nº SGI 3198065/12

4182E



Finishes: HDG, SS304, SS316

Characteristics:

- Metallic
- Non-flame propagating component
- Electrically conductive component
- With metallic coating. Resistance to corrosion:

HDG: class 6 SS304: class 9A SS316: class 9B

INSTRUCTIONS FOR USE

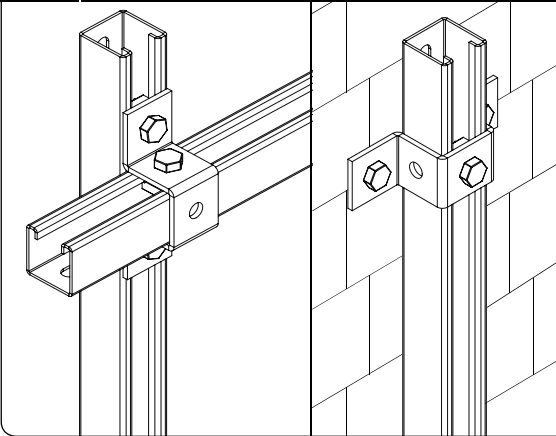

- Piece 4182E allows the assembly of two profiles in an angle of 90° by using bolts and spring nuts.
- To join profiles with 4182E, 3 M10 (or M8) spring nuts and 3 M10x30 DIN 933 Bolts (or 3 M8x30 DIN 933 + 3 M8 DIN 9021 washers) are required.
- It is usually assemble together with other accessories of the BASORPERFIL 41/82 family for the construction of RACKS and supports to fix cable trays in galleries and tunnels.
- The 4182E allows the wall mounting of the 41x41 profile by using two SCM12x8 anchors, one TM41 M10 and one Bolt M10x30 DIN933.

WORKING LOAD

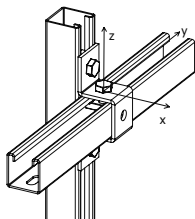

ASSEMBLY 1

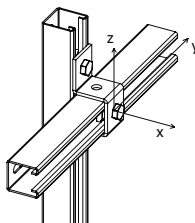

ASSEMBLY 2

ADMISSIBLE EFFORTS			
	Mx	Fx	Fz
	kg.m	kg	kg
4182E ASSEMBLY 1	26.5	1000	885
4182E ASSEMBLY 2	13	1500	935

Declared values include 1.7 safety factor as requested in EN IEC 61537 for cable tray supports.

NOTE: If the assembly is done by means of spring nuts, Fx and Fz load values are limited by the maximum traction/sliding values of the spring nut (350/700 kg).

Related products:

BASORPERFIL 41/82 profiles and accessories.